



## Elipse® Full Face Mask with P3 filters

Protecting you for  
life's best moments.

WWW.GVS.COM



H: 178 mm D: 130 mm W: 166 mm



H: 97 mm D: 11 mm W: 53 mm

**Encapsulation (patented technology)**  
total length of 645 mm media in each filter

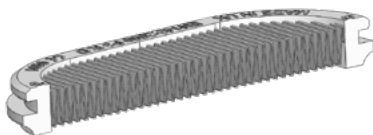

### Standards

Facemask EN 136:1998 Class 1  
EN166:2001 Class 1 & K (anti-scratch)  
Particle filter EN 143:2021 P3  
100% of filters NaCl Tested

### Efficiency

P3 >99,95% for 0,3 µ particulate

### Weight

Mask + Filters: 400 g  
Filters: 50 g

### Shelf Life

5 years (mask & filters) See storage  
conditions on Instructions for Use.  
Filters are re-usable and changeable.



### Material

- Inner mask body in Medical Grade TPE
- Visor in polycarbonate overmolded with silicone frame
- Headband in silicone
- Covers in PE
- Valve body in nylon with silicone diaphragms
- Filters in mechanical type multi-layer HESPA Synthetic media with TPE flexible overmolded / encapsulated

### Part #

### Description

FFM2243



Elipse® Full Face P3 Respirator  
Package also includes:  
■ Replaceable filters

SPR316



Elipse® P3 Replacement Filters  
Pair

SPM1001



Elipse® Full Face Carry Case

SPM1002



Elipse® Full Face Face Fit Test

SPM1003



1 pc Tearoff Kit

## Applications



**Welding and Grinding:** Metal Fumes and Dust.



**Constructions:** Silica Dust, Asbestos, Concrete Dust, Stone Dust, Aggregate Dust, Wood Dust, Cement Dust, Mold.



**Manufacturing:** Glass Fibers, Composite Fibers, Lead Fumes.



**Mining:** Coal Dust, Silica Dust.



**Food Industry:** Poultry, Powders (Dairy), Spices, Grain Dust.



**Pharmaceutical:** Powders, Viruses, Bacteria.