



INSPECTION

CAMERA

92577



UK
CA CE

INTRODUCTION:
USER MANUAL FOR:
Inspection Camera
Stock No: 92577, Part No: IC100

REVISIONS:

Date first published June 2019

Revision date May 2024

As our user manuals are continually updated, users should make sure that they use the very latest version.

Downloads are available from:

<http://drapertools.com/manuals>

Draper Tools

Draper Tools Limited, Hursley Road,
Chandler's Ford, Eastleigh, Hampshire,
SO53 1YF UK

Delta International

Delta International BV, Oude Graaf 8,
6002 NL, Weert Netherlands

Website: drapertools.com

Product Helpline: +44 (0) 23 8049 4344

General Fax: +44 (0) 23 8026 0784

**UNDERSTANDING THIS MANUAL'S
SAFETY CONTENT:**

WARNING! – Information that draws attention to the risk of injury or death.

CAUTION! – Information that draws attention to the risk of damage to the product or surroundings.

COPYRIGHT © NOTICE:

Copyright © Draper Tools Limited.
Permission is granted to reproduce this publication for personal and educational use only. Commercial copying, redistribution, hiring or lending is prohibited.

No part of this publication may be stored in a retrieval system or transmitted in any other form or means without written permission from Draper Tools Limited.

These instructions accompanying the product are the original instructions. This document is part of the product, keep it for the life of the product passing it on to any subsequent holder of the product. Read all these instructions before assembling, operating or maintaining this product.

WARRANTY

12 month Warranty -
Visit drapertools.com/warranty for full details

INTRODUCTION

SCOPE

Inspection camera allowing image capturing and video recording, which gets stored directly to an SD card.

Uses include pipe work, sewage inspection, machine equipment, engines, parts assembly, construction sites, etc.

Any other application beyond the conditions established for use will be considered misuse.

SPECIFICATION

Stock No.....	92577
Part No.	IC100
Camera.....	2MP (640x480, 1280x720)
Focal distance	30-80mm
Battery life (full charge)	240mins (approx)
Lighting type	6 LED's
IP rating	IP67
SD card	8GB Micro (supplied)

TECHNICAL DESCRIPTION

IDENTIFICATION

- ① LED indicator.
- ② On/Off button.
- ③ Snapshot/recording.
- ④ Screen rotation/up.
- ⑤ LED on/off/down.
- ⑥ Menu.
- ⑦ OK/play.
- ⑧ USB charging input.
- ⑨ SD card slot.
- ⑩ Reset.
- ⑪ Battery compartment.
- ⑫ Magnet.
- ⑬ Hook.
- ⑭ Mirror.
- ⑮ Camera protection cap.
- ⑯ Fixing sleeve.
- ⑰ Camera.
- ⑱ Semi rigid probe.



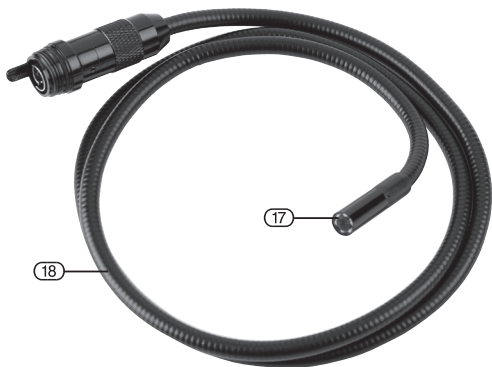
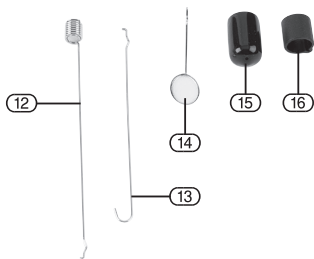

OPERATION

1. Depress thumb area on handle to release the battery compartment (11). Load 4 x AA batteries (not included) and push closed.
2. Connect the probe (18) to the head unit (19) ensuring the pins engage securely. Slide locking sleeve upwards and tighten in a clockwise direction.
3. Press and hold the On/Off button (2) for 2-3 Seconds.

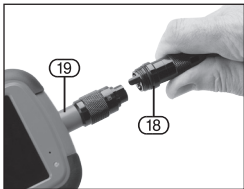
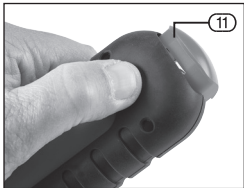

DISPOSAL

At the end of its working life, dispose of the product responsibly and in line with local regulations. Recycle where possible.

- **DO NOT** dispose of this product with domestic waste; most local authorities provide appropriate recycling facilities.
- **DO NOT** burn or mutilate batteries; this may release toxic or corrosive substances.

