

Single Acting Hollow Centre Cylinder – TCH Series

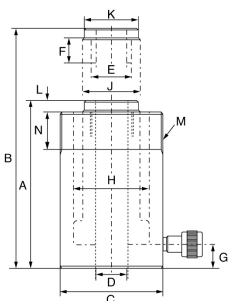

TECPOS

- Maximum Pressure: 700 Bar.
- Hydraulic Coupler: TBC 381F(PT3/8).
- Orange painted finish.
- Designed for use with screws, rods, cables & pullers.
- Marked with CE, capacity, manufacturers ID, product ID mark and traceability code.
- Certs available **2.1** **DoC**

| Product Code | Cyl. Cap. | Stokre | Cyl. Effec. Area | Oil Capacity | A | B | C | D | E | F | G | H | J | K | L | M | N | Weight | Pump |
|--------------|-----------|--------|------------------|--------------|-----|-----|-----|------|-----------|----|----|-----|-----|-----|----|----------|----|--------|----------|
| | t | mm | cm ² | cc | mm | mm | mm | mm | | mm | mm | mm | mm | mm | mm | mm | mm | kg | |
| TCH128 | 12 | 8 | 18.4 | 14.7 | 55 | 63 | 69 | 17.3 | 3/4"-16un | 16 | 20 | 54 | 35 | - | - | 2 3/4-16 | 20 | 1.7 | 1B or 08 |
| TCH1241 | 12 | 41 | 17.6 | 70.5 | 121 | 162 | 69 | 20 | - | - | 25 | 54 | 35 | - | 2 | - | - | 2.7 | 1B or 08 |
| TCH1276 | 12 | 76 | 17.6 | 133.7 | 184 | 260 | 69 | 20 | - | - | 25 | 54 | 35 | - | 2 | 2 3/4-16 | 30 | 4.5 | 1B or 08 |
| TCH2050 | 20 | 50 | 31.67 | 158.4 | 162 | 212 | 98 | 27 | 19/16-16 | 24 | 20 | 73 | 54 | 53 | 6 | - | - | 7.5 | 1B or 08 |
| TCH20150 | 20 | 150 | 31.67 | 475 | 295 | 445 | 98 | 27 | 19/16-16 | 24 | 25 | 73 | 54 | 53 | 7 | - | - | 16 | 1B or 08 |
| TCH3063 | 30 | 63 | 47.7 | 300.6 | 179 | 242 | 115 | 33 | M48XP1.5 | 20 | 21 | 90 | 65 | 63 | 11 | - | - | 10.7 | 1B or 08 |
| TCH30150 | 30 | 150 | 47.7 | 716 | 320 | 470 | 115 | 33 | M48XP1.5 | 20 | 24 | 90 | 65 | 63 | 11 | - | - | 20.2 | 1C or 17 |
| TCH6075 | 60 | 75 | 87.46 | 656 | 249 | 324 | 158 | 54 | M70XP2.0 | 28 | 30 | 125 | 95 | 92 | 15 | - | - | 27.6 | 1C or 17 |
| TCH60150 | 60 | 150 | 87.46 | 1311 | 334 | 484 | 158 | 54 | M70XP2.0 | 28 | 30 | 125 | 95 | 92 | 15 | - | - | 38 | 1C or 17 |
| TCH10075 | 100 | 75 | 143.13 | 1049 | 254 | 329 | 216 | 80 | M103XP2.0 | 28 | 35 | 170 | 130 | 127 | 15 | - | - | 51.5 | 1C or 17 |