

Guide to Assembly & Usage

Flat Pack Stackable Picking Bin

Information
If in doubt, contact the supplier

Read this Guide thoroughly before commencing assembly & retain for future reference

Before commencing assembly, unpack carefully & check that all components ordered are included

Caution
During assembly, ensure to:

Take care during assembly & in use, particularly when lifting or stretching & when using tools

Assemble & locate for use on a suitable level surface. Allow adequate working space

Dispose of packaging materials responsibly

Warning
Rules for the safe use of picking bins:

NEVER CLIMB ON THE STRUCTURE OR STAND ON THE BINS

DO NOT LEAN OR SUPPORT LADDERS, STEPS, OR OTHER OBJECTS AGAINST BINS

Do not use in damp or wet conditions

This product is designed for hand loading only

ENSURE THAT THE MAXIMUM LOAD CARRYING CAPACITIES ARE NOT EXCEEDED

Max box capacity set to 20kg

Picking Bins are safe when used responsibly. If in doubt, contact your supplier



COMPONENT CHECK LIST

Component	Quantity	H x W x D (mm)	Code
Flat pack stacking pick bin	10	200 x 400 x 600	SP - SPB642
Flat pack stacking pick bin	10	341 x 400 x 600	SP - SPB643
Flat pack stacking pick bin	10	420 x 400 x 600	SP - SPB644
Flat pack stacking pick bin	4	500 x 800 x 600	SP - SPB685

If you have any missing components please take note of the part name and code and contact your supplier

Assembly - Flat Pack Stackable Picking Bin

1 Fold front to panels in towards the centre.

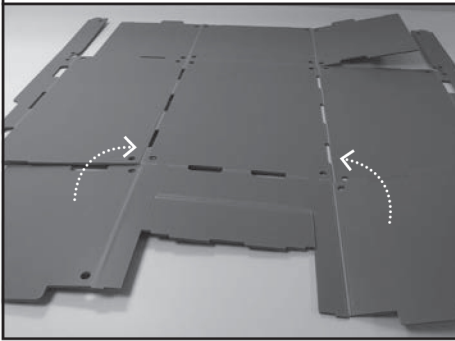

2 Tip backwards so the front of the bin stands at 90°.

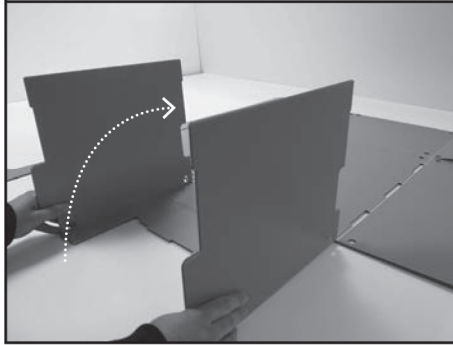

3 Push the tabs into the hole.

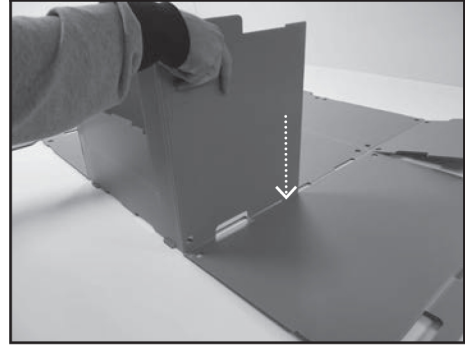

4 Fold front edge over and tuck into holes in base.

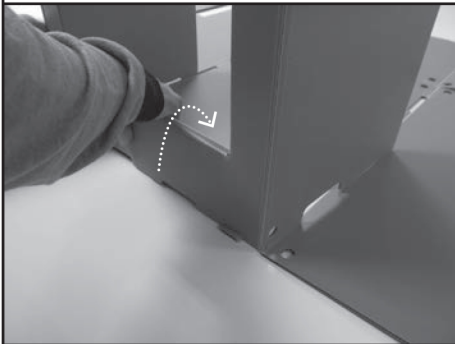

5 Fold back panels into the centre to meet front panels.

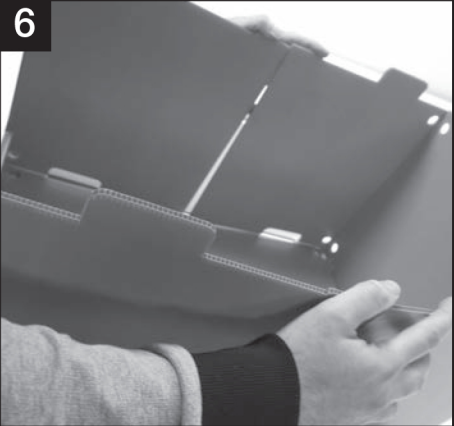
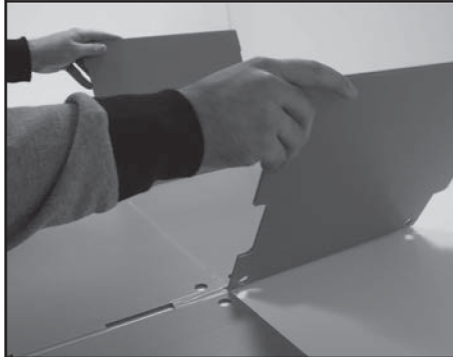

7 Tip the bin on to its side and fold over the top flap.

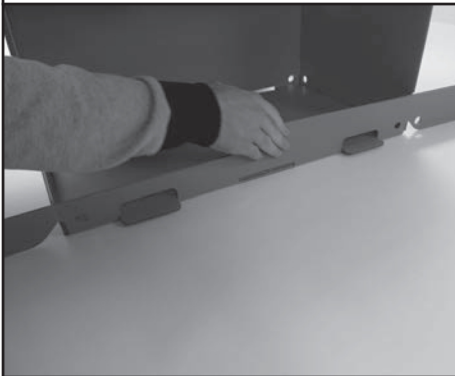

9 Stand up right and push the tabs in to the front to secure the top flaps.

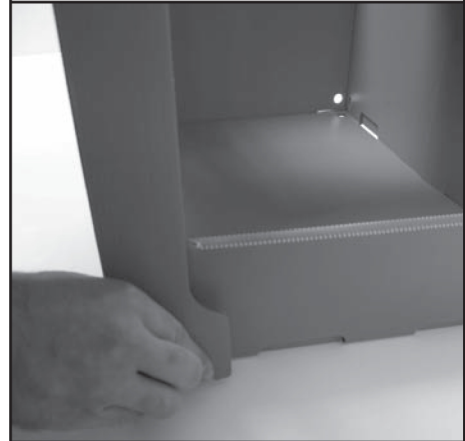

10 Then push the tabs in at the back.

